

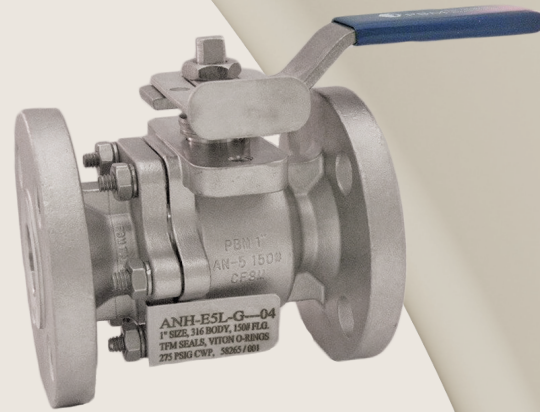

Breakthrough
engineering for
a better world

Process
Automation

IMI PBM



AN Series 5 Sizes 1/2" to 6"

Industrial ANSI Valves 150# & 300#

Design Features

- Valves are rated for full vacuum
- Valves have blowout proof stem
- Unique Adjust-O-Seal® feature allows in-line seat adjustment to compensate for normal wear
- AN Series ANSI valves have an O-Ring body seal
- Valves are a two-piece "split body" design with flanges per ANSI B16.5 and face-to-face dimensions that conform to ASME B16.10 long pattern
- Standard Live Loaded Stem packing
- Upstream and downstream bubble-tight sealing capability allows valve body cleaning, purging and draining
- Valves meet API 641, 200°F Max
- Encapsulated ID seat design - useable for some steam applications
- Valves are ADI free
- Stem assembly accommodates IMI PBM Direct Mount Actuation for accurate alignment and increased cycling life
- API-607 Fire Test Qualified option available
- Optional purge port, milled ball flats, or drain holes in ball allow inline CIP to prevent clogging and plug formation
- Self-Flushing Ball and V-Ball options available
- Valves 100% tested per ASME/ANSI B16.34
- Valves are designed, assembled and tested at our factory in the U.S.
- V-TEF and S-TEF seats and seals are FDA Compliant and USP Class VI
- Material Test Report (MTRS) can be provided for wetted metal components

SPECIFICATIONS

AN SERIES 5 INDUSTRIAL BALL VALVES

Sizes	1/2" - 6" Series 5
Material	316 Stainless Steel, Hastelloy® C-276, Carbon Steel, others
Temperatures	-20°F to 450°F depending on seat and seal material
End Connections	150# and 300# RF Flange
Seats, Seals & Stem Packings	V-TEF™, S-TEF®, C-TEF™ others available
O-Rings	O-Ring Seal (FKM V1274-75/80, EPDM E3609-70, others available)
Body Bolts & Nuts	B16.34 bolting
Maximum Working Pressure	In accordance with B16.34

Size	CV Values (gpm)		
	Cv (gpm)	Weight 150# Class	Weight 300# Class
1/2"	13	3.5 lbs	4.8 lbs
3/4"	52	4.8 lbs	7.3 lbs
1"	80	8 lbs	11 lbs
1 1/2"	190	16 lbs	23 lbs
2"	400	25 lbs	30 lbs
3"	1,100	50 lbs	71 lbs
4"	2,400	96 lbs	130 lbs
6"	5,600	242 lbs	326 lbs

PRODUCT (1-2) MATERIAL (3-4)			SIZE (5) SERIES (6)		END CONNECTION (7-8)		SEAT / SEAL / O-RING (9)		PURGE PORT BALL OPTIONS (10-11)		BALL / STEM OPTIONS (12)		OPERATOR (13- 14)			POLISH OPTIONS (15)	
AN	H-	Cast 316/ 316L S/S	C	1/2"	5	L-	150# RF Flange	G	V-TEF™ Seats / Seals FKM O-Ring	--	No Purge Port or Ball Option	-	Standard Ball and Stem	--	W/ Standard Lever Handle	-	125 Ra ID Standard
	E-	Carbon Steel	D	3/4"		M-	300# RF Flange	J	V-TEF™ Seats / Seals / VTFE Cav Fill / FKM O-Ring	- 8	Self Flushing Ball	F	Internal / External Grounding	02	W/O Handle W/ Stem Actuator Prep	A	20 Ra ID
	C-	Hastelloy C-276	E	1"				Z	V-TEF™ Seats / Seals EPDM O-Ring	- V	Slotted V-Ball	G	17-4PH Stem	04	Locking Lever Handle	C	20 Ra ID / 32 Ra OD
	Y-	Hastelloy C-22	G	1-1/2"				2	V-TEF™ Seats / Seals / VTFE Cav Fill / EPDM O-Ring	- W	30° V-Ball			08	Gear Operator (Req'd for 6")	F	20 Ra ID after Electro Polish
	P-	AL6XN	H	2"				0	S-TEF™ Seats / Seals FKM O-Ring	- X	45° V-Ball			16	Extended Stem w/Lockable Handle (1/2" thru 4")		
		Other material options available - Contact IMI PBM	K	3"				H	S-TEF™ Seats / Seals FKM O-Ring	- Y	60° V-Ball			20	DA 80psig actuator		
			L	4"				0	S-TEF™ Seats / Seals EPDM O-Ring					27	DA 60psig actuator		More polish available - Contact IMI PBM
			M	6"										34	SR 80psig actuator		
														41	SR 60psig actuator		

Other purge port & ball options - Contact IMI PBM

Other seat/seal options available - Contact IMI PBM

Other operator options available - Contact IMI PBM

ANSI VALVE - LOCKING HANDLE

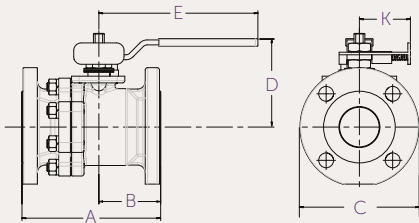

ANSI VALVE - EXTENDED STEM WITH LOCKING HANDLE

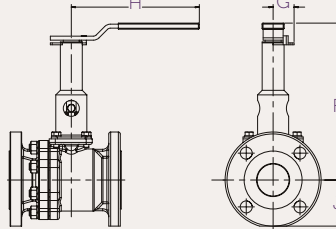

ANSI VALVE - GEAR OPERATOR [6" ONLY]

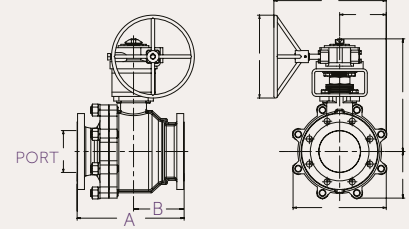

Valve Size	Size Code	Port Dia	A		B		C		D	E	J		Ext. Locking Handle			Locking Handle			
			Overall Length		CL to End		Flange Diameter				CL to top of Handle	Handle Length from CL	CL to Bottom		F	G	H	K	Hole Dia. for Lock
			150#	300#	150#	300#	150#	300#					150#	300#					
1/2"	C	0.50	4.25	5.50	1.85	2.52	3.50	3.75	2.66	4.15	1.62	1.75	5.12	0.95	5.09	1.62	.25		
3/4"	D	0.75	4.62	6.00	2.12	2.90	3.88	4.62	2.78	4.15	1.80	2.15	5.27	0.95	5.09	1.62	.25		
1"	E	1.00	5.00	6.50	2.25	3.15	4.25	4.88	3.09	5.09	2.06	2.38	5.61	0.10	5.09	2.08	.28		
1 1/2"	G	1.50	6.50	7.50	2.68	3.18	5.00	6.12	4.16	8.03	2.38	3.00	6.40	1.25	8.03	2.58	.38		
2"	H	2.00	7.00	8.50	3.12	3.84	6.00	6.50	4.46	8.03	2.88	3.12	6.71	1.25	8.03	2.58	.38		
3"	K	3.00	8.00	11.12	3.57	5.19	7.50	8.25	6.85	12.06	3.50	4.00	8.63	1.62	12.06	3.47	.38		
4"	L	4.00	9.00	12.00	3.84	5.34	9.00	10.00	9.00	24.06	4.38	4.75	9.90	2.25	24.06	NA	NA		
6"	M	6.00	15.50	15.88	7.33	7.70	11.00	12.50	NA	NA	6.75	7.72	NA	NA	NA	NA	NA		

	80 PSI Double Acting					60 PSI Double Acting					80 PSI Spring Return					60 PSI Spring Return				
Size	L	M	N	P	R	L	M	N	P	R	L	M	N	P	R	L	M	N	P	R
1/2"	5.55	2.80	5.84	1.61	1/8	5.55	2.80	5.84	1.61	1/8	5.55	2.80	5.84	1.61	1/8	6.46	3.17	6.29	1.77	1/8
3/4"	5.55	2.80	5.99	1.61	1/8	5.55	2.80	5.99	1.61	1/8	6.46	3.17	6.44	1.77	1/8	6.46	3.17	6.44	1.77	1/8
1"	5.55	2.80	6.71	1.61	1/8	5.55	2.80	6.71	1.61	1/8	8.27	3.72	7.87	2.07	1/8	8.27	3.72	7.87	2.07	1/8
1-1/2"	6.46	3.17	8.44	1.77	1/8	8.27	3.72	9.15	2.07	1/8	10.83	4.84	10.20	2.68	1/4	10.83	4.84	10.20	2.68	1/4
2"	8.27	3.72	9.45	2.07	1/8	8.27	3.72	9.45	2.07	1/8	10.83	4.84	10.50	2.68	1/4	13.11	5.39	11.86	2.87	1/4
3"	13.11	5.39	13.81	2.87	1/4	13.11	5.39	13.81	2.87	1/4	14.65	5.83	14.29	3.15	1/4	17.13	6.46	15.18	3.44	1/4
4"	17.13	6.46	17.34	3.44	1/4	17.13	6.46	17.34	3.44	1/4	19.69	7.32	18.28	3.90	1/4	19.69	7.32	18.28	3.90	1/4
6"	22.78	8.54	24.13	4.29	1/4	22.78	8.58	24.13	4.29	1/4	22.78	8.54	24.13	4.29	1/4	26.46	11.42	28.89	5.71	1/4

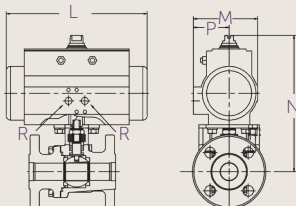

ACTUATED DIMENSIONS

Unit of measure = inches

Dimensions based on actuators used with V-TEF® seats

Find out more
pbmvalve.com

