



Breakthrough
engineering for
a better world

Process Automation

IMI PBM

SI Series 6 Size 1/2" to 4"

Igenix® Fire Tested 2-Way Ball Valves

Design Features

- Firesafe, tested to API-607
- SI Series 6 Firesafe valves have O-Rings
- Three-piece "swing out" body design
- Upstream and downstream bubble-tight sealing capability allows valve body cleaning purging and draining.
- True Bore® design
- Valves are rated for full vacuum
- Blowout Proof Stem
- Material Test Report (MTRs) provided for wetted components
- Surface finishes are achieved without the use of Animal Derived Ingredients (ADI)
- Optional Fusible Link - A Spring Return Handle Unit can be equipped with an optional fusible link specified to a customer's required melt temperature, which closes the valve during fire conditions.
- Direct mount automation

CV Values (gpm), Series 6		
Size	End Connections	
	F-	X-
1/2"	7	8
3/4"	24	28
1"	55	60
1 1/2"	160	190
2"	370	420
2 1/2"	700	800
3"	850	1,000
4"		

ID Surface Finish Ra Readings for Valves per ASME BPE			
Surface Finish	IMI PBM Polish Code	μ-in.	μ-m.
Mechanical Polish			
SF 1	A	20 Ra Max	0.51
SF 2	A	25 Ra Max	0.64
SF 3	-	30 Ra Max	0.76
Mechanical Polish & Electropolish			
SF 4	G	15 Ra Max	0.38
SF 5	F	20 Ra Max	0.51
SF 6	F	25 Ra Max	0.64

SPECIFICATIONS

Sizes
Material
Temperatures
End Connections
Seats & Seals
Stem Packing Material
Body Bolts & Nuts
Maximum Working Pressure
Polish

Igenix Fire Tested, 3 Piece, 2-Way Ball Valves

1/2" to 4"
316L, (ASTM A351 CFM), Hastelloy™ C726 and other materials
Ambient for V-TEF™ to 400°F, S-TEF® to 450°F
Extended tube, hygienic clamp, compression ends (1/2" to 1")
V-TEF™ or S-TEF® - Graphite seats, O-Rings (EPDM, FKM standard) - specifics
V-TEF™ or S-TEF® - Graphite secondary seals
18-8 Stainless Steel, fully encapsulated
Up to 720 psig CWP depending on valve series, size and temperature
Standard internal polish of 30 Ra ID



How To Order:
pbmvalve.com/build-a-part-number

PRODUCT (1-2) MATERIAL (3-4)			SIZE (5) SERIES (6)			END CONNECTION (7-8)		SEAT / SEAL (9)		PURGE PORT BALL OPTIONS (10-11)		BALL / STEM OPTIONS (12)		OPERATOR (13- 14)		POLISH OPTIONS (15)	
SI	H-	Cast 316/316L S/S	C	1/2"	6	F-	Ext. Butt weld for Tube	G	V-TEF™ Seats / Graphite Seals / FKM O-Rings	--	No Purge Port or Ball Option	-	Standard Ball and Stem	--	W/ Standard Lever Handle	-	30 Ra ID Standard
	HL	Cast 316L S/S	D	3/4"		FX	Ext. Butt weld for Tube by Hygienic Clamp	J	V-TEF™ Seats / Graphite Seals / VTFE Cav Fill / FKM O-Rings	- 8	Self Flushing Ball	G	17-4PH Stem	02	W/O Handle W/ Stem Actuator Prep	A	20 Ra ID
	C-	Hastelloy C-276	E	1"		X-	Hygienic Clamp	Z	V-TEF™ Seats / Graphite Seals / EPDM O-Rings	- V	Slotted V-Ball			04	Locking Lever Handle	C	20 Ra ID / 32 Ra OD
	Y-	Hastelloy C-22	J	2-1/2"		SM	Compression (thru 1")	2	V-TEF™ Seats / Graphite Seals / VTFE Cav Fill / EPDM O-Rings	- W	30° V-Ball			18	Extended Handle (1/2" thru 3")	F	20 Ra ID after Electro Polish
	P-	AL6XN	K	3"		G-	Female Cherry Burrell	H	V-TEF™ Seats / Graphite Seals / FKM O-Rings	- X	45° V-Ball			20	DA 80psig actuator		
						H-	Male Cherry Burrell	0	S-TEF® Seats / Graphite Seals / EPDM O-Rings	- Y	60° V-Ball			27	DA 80psig actuator		
								9	V-TEF™ Seats / Seals / FEP Encaps. FKM O-Rings					34	SR 80psig actuator		
														41	SR 60psig actuator		

Other material options available - Contact IMI PBM

Other Purge Port & Ball options - Contact IMI PBM

Other operator options available - Contact IMI PBM

More polish available - Contact IMI PBM

Other Seat/Seal options available - Contact IMI PBM

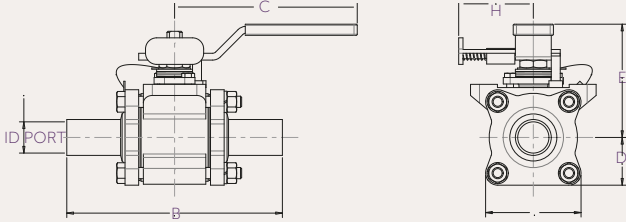

2-WAY FIRE RATED VALVE WITH LOCKABLE HANDLE

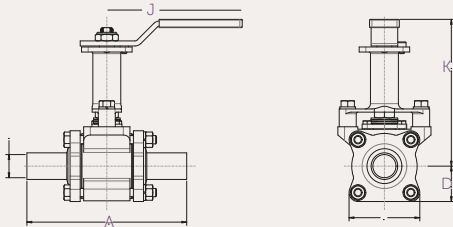

2-WAY FIRE RATED VALVE W/EXT LOCKABLE HANDLE

2-Way Sanitary Firesafe Valve Dimensioned (Valves in Inches)											Locking Handle		Extended Lockable Handle		
Valve Size	Size Code	ID Port	Tubing Gauge	A Clamp	B Weld	C	D	E	~Wt (lbs)	H	Hole Dia. for Lock	J	K	Hole Dia. for Lock	
1/2"	C	0.37	16 ga	3.50	5.50	4.15	0.92	2.63	1.6	1.62	0.28	5.09	4.00	0.31	
3/4"	D	0.62	16 ga	4.00	5.50	4.15	0.92	2.63	1.6	1.62	0.28	5.09	4.14	0.31	
1"	E	0.87	16 ga	5.37	6.00	5.09	1.33	3.03	4.5	1.62	0.25	5.09	5.44	0.31	
1-1/2"	G	1.37	16 ga	5.50	7.50	8.03	1.78	4.10	10	2.57	0.38	8.00	7.46	0.38	
2"	H	1.87	16 ga	6.25	8.00	8.03	2.15	4.41	15.3	2.57	0.38	8.00	9.76	0.38	
2-1/2"	J	2.37	16 ga	8.00	11.50	12.06	2.79	6.51	36	3.47	0.38	12.06	11.36	0.38	
3"	K	2.87	16 ga	9.00	13.50	12.06	3.14	6.78	49	3.47	0.38	12.06	11.69	0.44	
4"															

ACTUATED DIMENSIONS

Unit of measure = inches
Dimensions based on actuators used with V-TEF® seats

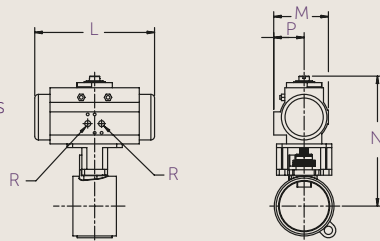

Find out more
pbmvalve.com

Size	80 PSI Double Acting					60 PSI Double Acting					80 PSI Spring Return					60 PSI Spring Return				
	L	M	N	P	R	L	M	N	P	R	L	M	N	P	R	L	M	N	P	R
1/2"	5.55	2.79	5.84	1.61	1/8	6.46	3.17	6.29	1.77	1/8	5.55	2.79	5.84	1.61	1/8	5.55	2.79	5.84	1.61	1/8
3/4"	6.46	3.17	6.44	1.77	1/8	6.46	3.17	6.44	1.77	1/8	5.55	2.79	5.99	1.61	1/8	5.55	2.79	5.99	1.61	1/8
1"	8.27	3.72	7.80	2.07	1/8	8.27	3.72	7.80	2.07	1/8	5.55	2.79	6.64	1.61	1/8	5.55	2.79	6.64	1.61	1/8
1-1/2"	10.83	4.85	10.16	2.68	1/4	10.83	4.85	10.16	2.68	1/4	6.46	3.17	8.39	1.77	1/8	8.27	3.72	9.10	2.07	1/8
2"	10.83	4.85	10.47	2.68	1/4	13.12	5.39	11.82	2.87	1/4	8.27	3.72	9.42	2.07	1/8	8.27	3.72	9.42	2.07	1/8
2-1/2"	13.12	5.39	13.48	2.87	1/4	14.65	5.83	13.96	3.15	1/4	13.12	5.39	13.48	2.87	1/4	13.12	5.39	13.48	2.87	1/4
3"	14.65	5.83	14.29	3.15	1/4	17.13	6.46	15.16	3.44	1/4	13.12	5.39	13.81	2.87	1/4	13.12	5.39	13.81	2.87	1/4
4"																				

Manual Valves with Tube Ends (when used with insulation)		
Tube OD	Insulation Max with No Extension	Insulation Max with Extension
0.50	0.76	2.68
0.75	0.79	2.72
1.00	1.45	3.88
1.50	3.10	5.57
2.00	2.31	5.60
2.50	4.00	8.88
3.00	4.08	8.88
4.00		

The information in this brochure is provided for informational/promotional purposes only and is "as is" and without warranties of any kind whether express or implied, including, but not limited to implied warranties of satisfactory quality, fitness for a particular purpose and/or correctness. Any specifications, features pricing, or availability contained in this bulletin are subject to change without prior notice. IMI Critical ENGR PBM LLC does not represent or warrant that the information and/or specification in this bulletin are accurate, complete, or current and therefore make no warranties or representation regarding the use of the content. IMI plc or one of its subsidiaries own all images, logos, product brands and trademarks mentioned in this bulletin. Unauthorized use, reproductions or modification of this content is prohibited. © Copyright 2024 IMI Critical ENGR PBM LLC. PB-S16-RB24. All Rights Reserved.

