



Breakthrough
engineering for
a better world

Process Automation

IMI PBM

TI Series 1" x 3" - 1" x 2" - 2 1/2" x 3" Flanges

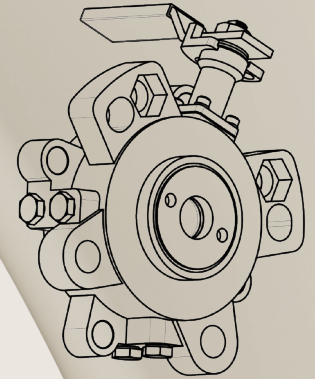

Transmitter Isolation Valves

Design Features

- TIV valves feature minimal dead space, which prevents build-up
- TI Series Valves do not have O-Rings
- Available in 150#, 300# and other sizes and pressure rating available
- Purge ports and optional milled flats enable CIP and drainage without process interruption.
- Bolt pattern accommodates standard industry ANSI 150# and 300# flanged connections and retrofits to knife gate patterns.
- Hardware configuration allows separate bolting of valve to tank and transmitter to valve as an additional safety measure for hazardous media.
- Calibration port, CIP ports and locking handle standard
- Valves are design to ASME B16.34

Best Transmitter Isolation Technology

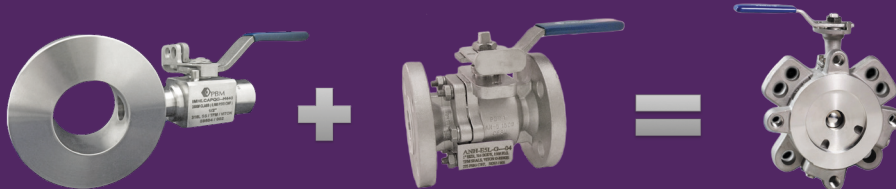

Full Port or True Bore® Port
ANSI Style Transmitter
Isolation Valves provide value
to the customer.

SPECIFICATIONS

Transmitter Isolation Valves

Sizes	1" Port x 3" Flanges; 1" Port x 2" Flanges; 2 1/2" Port x 3" Flanges
Material	316/317L Stainless Steel, Hastelloy™ C-276, C22®, Titanium or others
Temperatures	Ambient to 450°F depending on material
End Connections	(4) 1/4" FNPT plugged purge ports with hex head plugs
Seats, Seals and Stem Packings	V-TEF™ seats with VTFE O-Rings, S-TEF® with Teflon Encapsulated O-Rings
Body Bolts & Nuts	18-8 Stainless Steel
Maximum Working Pressure	Maximum CWP depending on flange rating and valve material of construction



How To Order:
pbmvalve.com/build-a-part-number

PRODUCT (1-2) MATERIAL (3-4)	SIZE (5) SERIES (6)	CLASS OF END CONNECTION (7)	TYPE OF END CONNECTION (8)	SEAT & SEAL/O-RING (9)	PURGE PORTS (10)	BALL FLAT OPTIONS (11)	BALL / STEM OPTIONS (12)
TI H- 316 Stainless	E 1"	S L 150# Flange	- 3 inch Flange	G V-TEF™ / VTFE	- Qty. 4, 1/4" Plugged Purge Ports w/ Hex Head Plugs	- Standard (no options)	- Standard (316/316L S/S Ball and Stem)
H2 317L Stainless	J 2-1/2"	M 300# Flange	H 2 inch Flange	H S-TEF® / FEP Encapsulated		A Flats closed downstream	F Internal / external grounding
C Hastelloy® C-276						B Flats closed upstream	G 17-4PH stem
Y Hastelloy® C-22®						C Flats open upstream	
T Gr. 5 Titanium						D Flats open downstream	
HC Alloy 20						E Flats open upstream & downstream	

1" Port x 3" 150# Flanged TIV

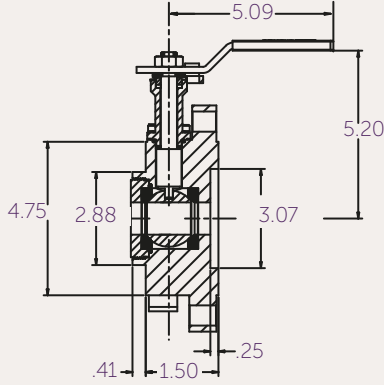

1" Port x 2" 150# Flanged TIV

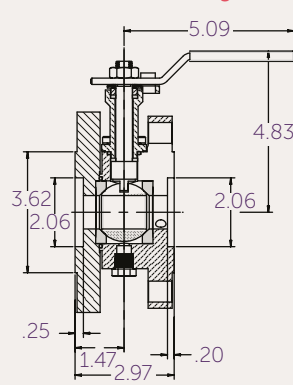

2 1/2" Port x 3" 150# Flanged TIV

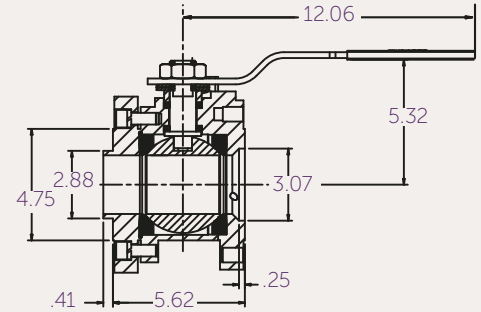

1" Port x 3" 300# Flanged TIV

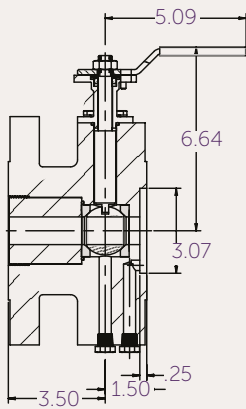

1" Port x 2" 300# Flanged TIV

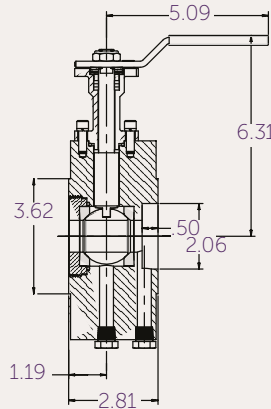

2 1/2" Port x 3" 300# Flanged TIV

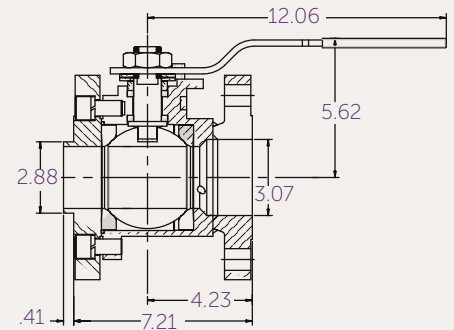

1" Port x 3" 150# Flanged TIV

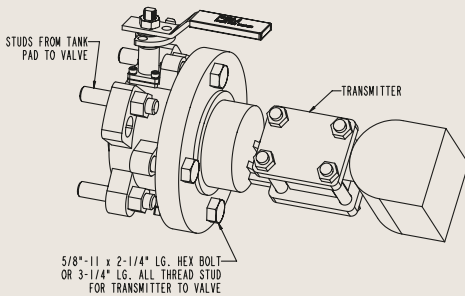

2 1/2" Port x 3" Flanged TIV

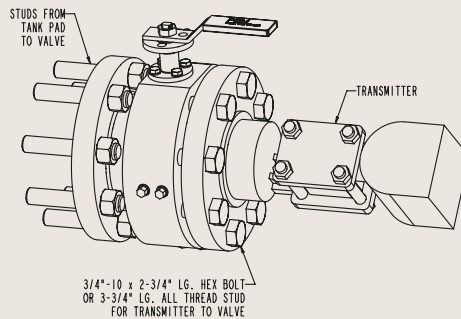

Tank View

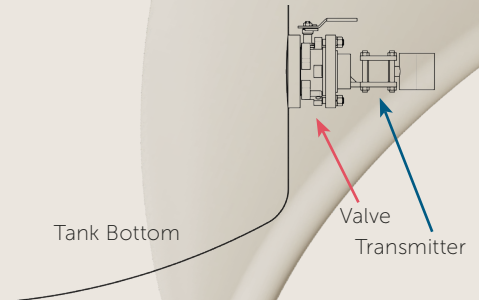

Find out more
pbmvalve.com



The information in this brochure is provided for informational/promotional purposes only and is "as is" and without warranties of any kind whether express or implied, including, but not limited to implied warranties of satisfactory quality, fitness for a particular purpose and/or correctness. Any specifications, features, pricing, or availability contained in this bulletin are subject to change without prior notice. IMI Critical ENGR PBM LLC does not represent or warrant that the information and/or specification in this bulletin are accurate, complete, or current and therefore make no warranties or representation regarding the use of the content. IMI plc or one of its subsidiaries own all images, logos, product brands and trademarks mentioned in this bulletin. Unauthorized use, reproductions or modification of this content is prohibited. © Copyright 2024 IMI Critical ENGR PBM LLC. PB-TIV-RB24. All Rights Reserved.